

FIRST FLOOR PLAN (BUILTUP AREA = 183.22 SQ.M.)

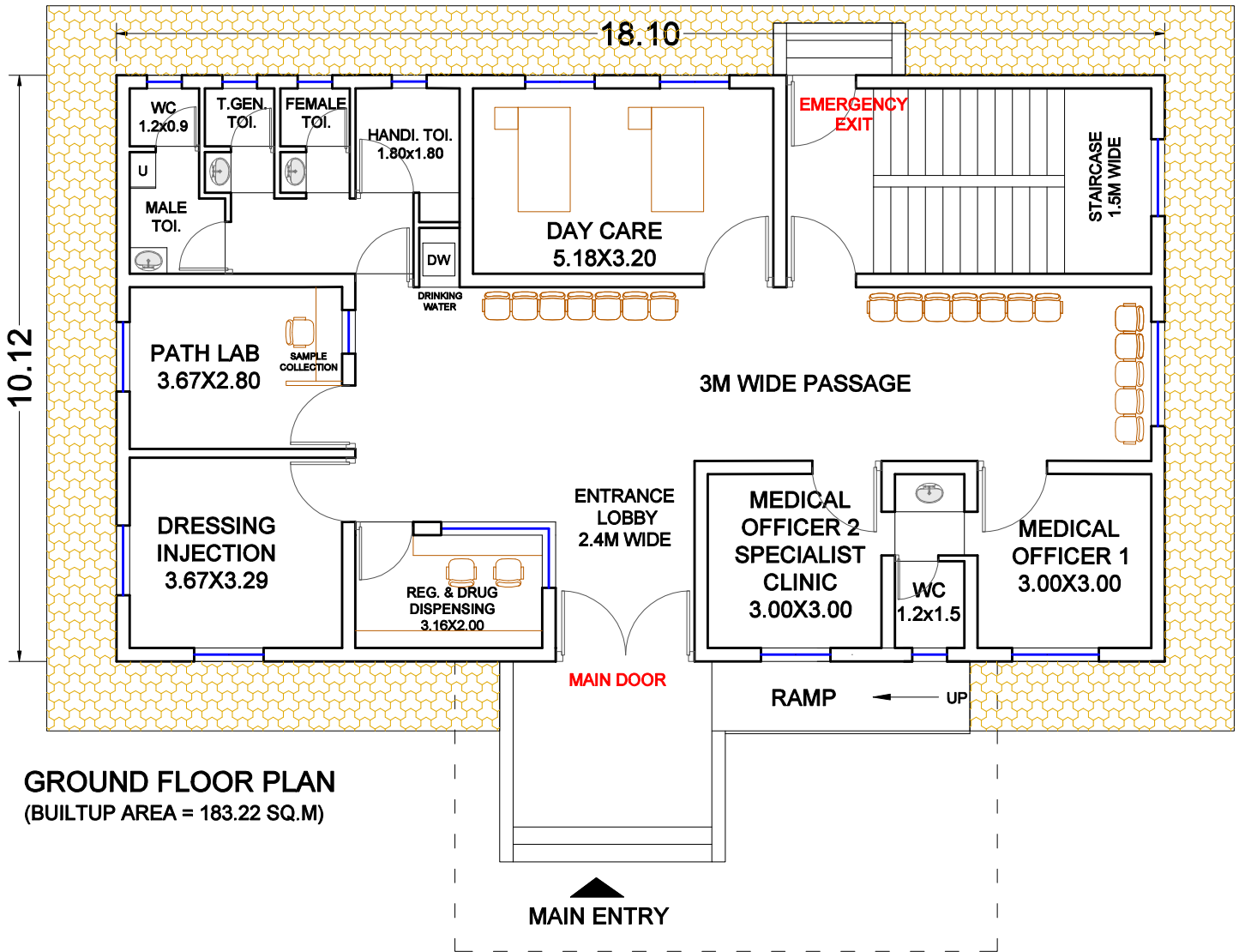

GROUND FLOOR PLAN (BUILTUP AREA = 183.22 SQ.M)

PROPOSED URBAN PHC PLAN FOR IPHS

TOTAL BUILTUP AREA GROUND + FIRST FLOOR = 366.44 SQ.M